

Dry Community Gardens

Dry gardens are often low in maintenance as the plants do not often require pruning or fertilizing. Most plants in Dry Gardens are also drought tolerant, which hence requires a less often watering regime due to their adaptations to dry and arid climates.





Community Garden at Yokogawa



Community Garden at Lakeside Grove

Growth Conditions for Dry Gardens

Light Requirement 	Water Requirement 	Soil Requirement 	Fertilising Regime
<ul style="list-style-type: none">• Full Sun is preferred as many of the plants in a dry garden have a natural habitat in deserts with full sun.	<ul style="list-style-type: none">• Little water is required for the plants implemented in dry gardens as they are acclimatised to environments with little source of water.	<ul style="list-style-type: none">• Sandy Soil (Soil with good drainage)	<ul style="list-style-type: none">• No need for fertilising

Recommended Plants



Variegated Caribbean Agave
(*Agave angustifolia* 'Marginata')
Height: 0.5m – 0.9m



Aloe Vera
(*Aloe vera*)
Height: 0.4m – 0.6m



Euphorbia trigona
(*Euphorbia trigona* 'Royal Red')
Height: 1m – 2m



Golden Barrel Cactus
(*Echinocactus grusonii*)
Height: 0.5m – 1m



Golden Bird's Nest
(*Sansevieria trifasciata* 'Hahnii')
Height: 0.2m – 0.3m



Dwarf Kalanchoe
(*Kalanchoe pumila*)
Height: 0.1m – 0.3m

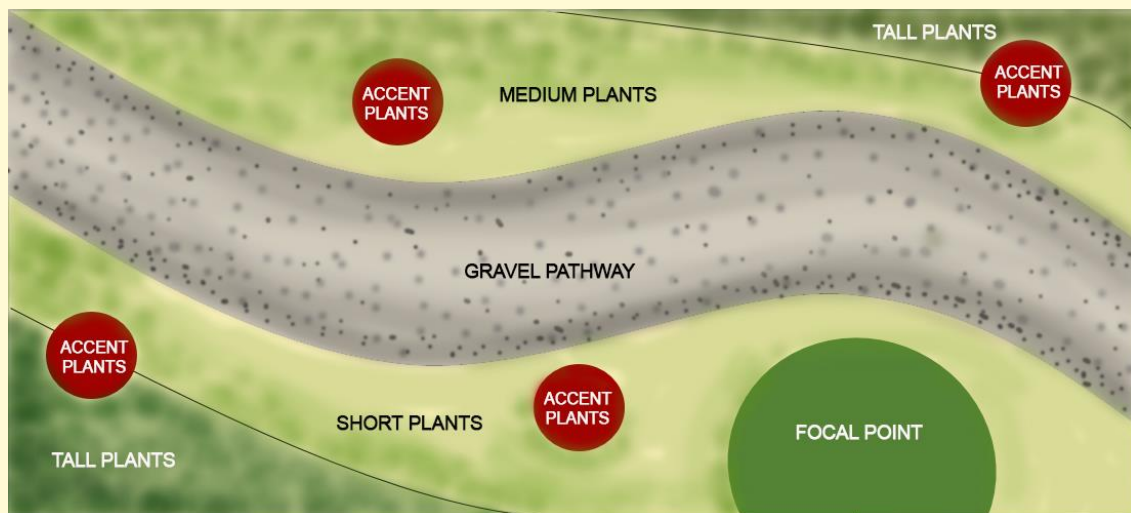

Example of a Garden Layout (Accent plants are plants placed within a monotonous plot to stand out)

For a step by step process, you can refer to 'Planning Your Community Garden' handout.

For more information on plant selection and plant choices, refer to <https://florafaunaweb.nparks.gov.sg>