

Your Guide to Lakeside Garden

Lakeside Garden is the 53-hectare western section of Jurong Lake Gardens, Singapore's third National Garden, and the first in the heartlands. During its development, great care was taken to conserve the existing biodiversity while incorporating elements of community and play for visitors.

Consisting of a matrix of ecological habitats such as a freshwater swamp forest and grasslands, Lakeside Garden is home to a diverse collection of flora and fauna. Alongside efforts made to conserve its original biodiversity, other species have been specially curated for visitors to appreciate nature's beauty. For example, the Rosy Trumpet trees and Pink Mempat trees that line the Northern Spine of Lakeside Garden bloom in a spectacular trail of pink!

As a people's garden, there are plenty of community spaces for events and gatherings. Nature-themed play areas like Forest Ramble and Clusia Cove are popular with families looking for a fun day out. Visitors can also enjoy recreational activities, such as cycling and fishing, at designated locations.

How to get here:

- By Car or Taxi
 - Turn in at Chinese Garden Road into North Carpark OR
 - Turn in at Japanese Garden Road into South Carpark
- By MRT
 - Nearest MRT station: Lakeside
 - From Lakeside MRT station, take Exit A. Walk along the sheltered pathway to the North Entrance of Lakeside Garden
- By Bus
 - Bus services: 49, 154, 154B, 240, 246 (Stop along Yuan Ching Road)

Trail highlights

- Observing interesting plant and animal species
- Appreciating the Pink Tree collection along the Northern Spine
- Enjoying the beautiful scenery as you stroll along Jurong Lake
- Playing at the water play area at Clusia Cove
- Playing at the nature-themed play areas at Forest Ramble

Tips for a safe and enjoyable visit

- Dress comfortably and wear suitable footwear
- Wear a hat, put on sunglasses and apply sunscreen to shield yourself from the sun
- Spray on insect repellent if you are prone to insect bites
- If you intend to let your children play at the water playground, bring extra clothing and towels
- Drink ample fluids to stay hydrated
- Walk along the designated paths to protect the park's natural environment
- Dispose of rubbish at the nearest bin
- Activities such as poaching, releasing and feeding of animals, damaging and removal of plants, and those that cause pollution are strictly prohibited
- Keep your pets leashed and clean up after them



Your Guide to Lakeside Garden

Mempat Trail

Distance: 1.75 km

Estimated time: 30 minutes

Terrain: Level ground. Apart from the water play area within Clusia Cove, most attractions on this trail are wheelchair friendly.

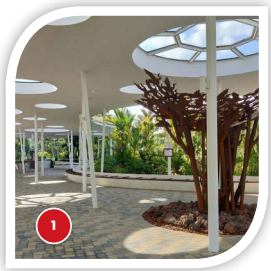

Entrance Pavilion



The Canyon



Clusia Cove



ABC Waters



PAssionWaVe

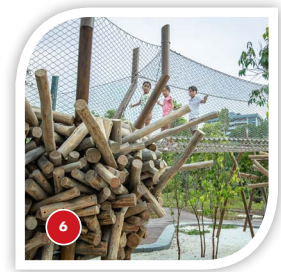

Forest Ramble

Legend

- Information
- Drop-off point
- F&B
- Vending Machine (Drinks/Hot Food/Retail)
- Drinking Fountain
- Shelter
- Toilet
- Nursing Room
- Fitness Corner
- BBQ Pits
- Gate
- MRT
- Bicycle Parking
- Coach Parking
- Public Bus Stop
- Carpark
- Building / Facilities
- Automated External Defibrillator



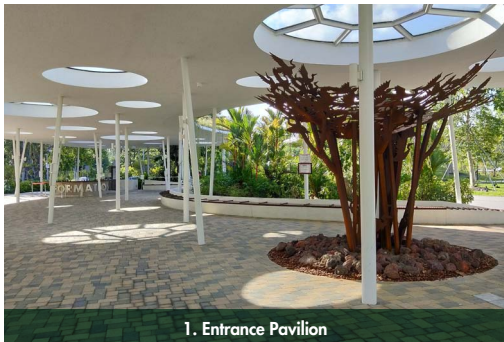

1. Entrance Pavilion



3. Clusia Cove



Eco Pond



4. ABC Waters Jurong Lake

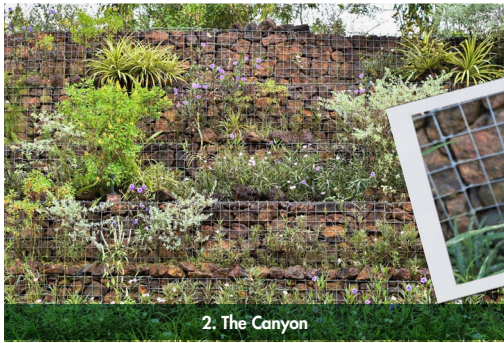

2. The Canyon



Mexican Petunia



Weeping Fig



Yellow-vented Bulbul



Malayan Water Monitor

▶ 1 Entrance Pavilion

Designed to resemble the crown of a Malayan Banyan (*Ficus microcarpa*), the Entrance Pavilion is where you can start your journey. Look up and imagine yourself standing under the restful shade of the Malayan Banyan, with rays of sunlight occasionally penetrating the canopy. Our friendly Visitor Services counter staff will be glad to help with any queries that you might have.

▶ 2 The Canyon

The reddish-orange rocks that make up the gabion walls of The Canyon were salvaged from excavated boulders during Lakeside Garden’s development. Now they give new life to the plethora of plant species that grow on them. Amongst these are the **Bamboo Orchid** (*Arundina graminiflora*) and **Mexican Petunia** (*Ruellia simplex*) with their vibrant pink and purple flowers.

The striking contrast between the red bricks and lush greenery makes The Canyon a popular spot to take that perfect Instagram photo.

▶ 3 Clusia Cove

Clusia Cove features two water play areas, an Eco Pond, a pavilion and a café. The Sand Play Pool and the Tidal Play Pool are designed to simulate the various unique interactions found in natural coastline environments. The water in Clusia Cove runs through a closed-loop circulation system. As water from the play areas flow into the Eco Pond, it is filtered by a cleansing biotope consisting of aquatic plants. The water is then disinfected in an underground UV room before returning to the water play areas.

Clusia Cove is home to a diverse range of plants commonly found in freshwater wetland ecosystems. For example, the **Swamp Lily** (*Thalia geniculata*) is one of the aquatic plants that makes up the cleansing biotope. Notice how its paired purple flowers sport a uniquely irregular shape. Do also look for the white and pink flowers of the **Autograph Tree** (*Clusia rosea*) from which Clusia Cove gets its name.

Overlooking the Eco Pond is a café where families can enjoy a variety of Asian and Western dishes.

Along the way to the next landmark, you will be welcomed by a cluster of towering fig trees. This includes the **Weeping Fig** (*Ficus benjamina*) whose fruit attracts a large variety of birds and insects. See if you can catch a glimpse of the bright yellow bottom of the **Yellow-vented Bulbul** (*Pycnonotus goiavier*). It usually forages for fruit and insects here. Notice how the black patch around its eyes makes it look as if it is wearing an eye mask!

▶ 4 ABC Waters Jurong Lake

As you enjoy an unobstructed view of Jurong Lake, notice the numerous floating wetlands that dot the water’s edge. These floating wetlands consist of emergent plants growing on floating mats. Their roots absorb minerals from the water, filtering it in a process called phytoremediation. Try visiting the nearby boardwalk for a closer look.

The **Malayan Water Monitor** (*Varanus salvator*) can be commonly seen emerging from the water and basking under the sun. It can sometimes be observed crossing the footpaths as well. Be careful not to disturb it!

As you progress on this trail, you might have noticed the beautiful pink flowers present on some trees along the way. These belong to Lakeside Garden’s collection of specially curated Pink Trees, consisting of species such as the **Rosy Trumpet Tree** (*Tabebuia rosea*) and **Pink Mempat** (*Cratoxylum formosum*). Following prolonged dry weather, these trees flower profusely, producing clusters of flowers that end up covering the trail below in a beautiful mat of pink.

Located within the gardens is also Waterways Watch Society, an independent volunteer group that brings people together to love our waterways and inspire environmental stewardship.

Visit <http://www.wws.org.sg> for its latest calendar of events



Rosy Trumpet Tree



5. PAssion WaVe



Crab Play (Forest Ramble)

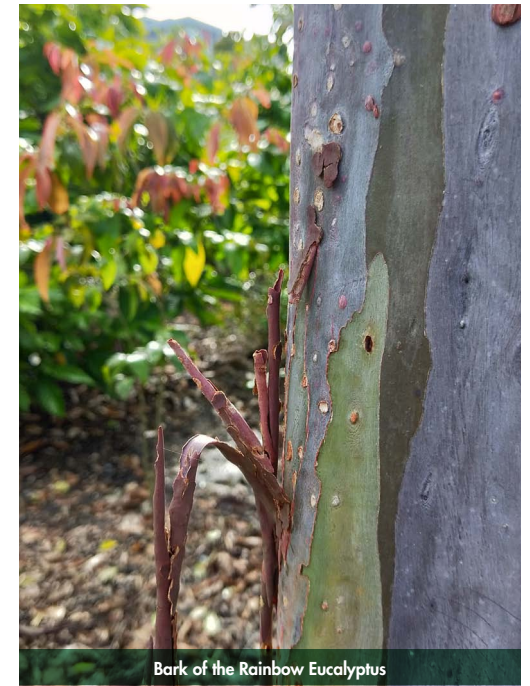

Bark of the Rainbow Eucalyptus



Pink Mempat



6. Forest Ramble



Frog Play (Forest Ramble)

▶ 5 PAssion WaVe

PAssion WaVe @ Jurong Lake Gardens is the first waterfront facility in the west. There is a wide variety of unique water sports and lifestyle programmes for everyone here.

Visit <https://www.pa.gov.sg/our-programmes/PAssion-WaVe> for its latest calendar of events.

▶ 6 Forest Ramble

Centred on the concept of Biophilia, Forest Ramble is the largest nature playgarden in the heartlands. The 13 exciting adventure stations enable children to explore and emulate the movement of animals that typically inhabit a freshwater swamp forest. Whether to soar on gliders at Heron Play or leap on trampolines at Frog Play, the choice is yours! There are also inclusive play elements, such as a wheelchair-friendly swing and musical play panels.

The plants within Forest Ramble have been specially chosen for their unique shapes, textures and colours to stimulate our senses. Look at how the **Rainbow Eucalyptus** (*Eucalyptus deglupta*) has a beautiful multi-coloured trunk, shedding its bark to display hues of blue, green and orange. The **Paper Bark Tree** (*Melaleuca cajuputi*) has a spongy trunk and many layers of bark that seem to be flaky and peeling. Forest Ramble is also home to a diversity of butterflies. Marvel at the vibrant colours of the **Common Grass Yellow** (*Eurema hecabe*) and **Plain Tiger** (*Danaus chrysippus*) if you can spot them!

We hope you have enjoyed your walk on this trail. If you wish to explore more of Lakeside Garden, do consider embarking on the Banyan Trail.

www.nparks.gov.sg/eguides

Photo credits:
Pink Mempat: Celine Ng, NParks Flora&FaunaWeb
Common Grass Yellow: Khew Sin Khoon
Plain Tiger: Loke Peng Fai
Paper Bark Tree: Teo Siyang



Common Grass Yellow



Plain Tiger



Paper Bark Tree

Your Guide to
Lakeside Garden