

# BUKIT TIMAH RAILWAY STATION

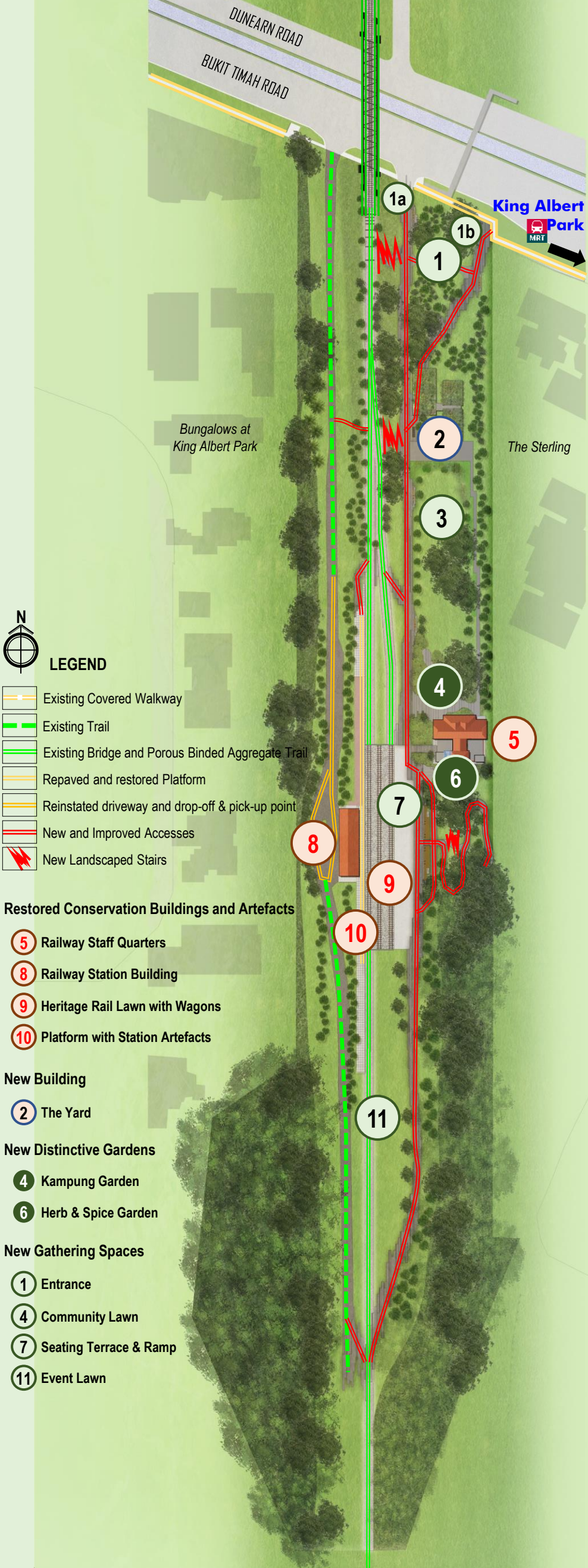

The design of newly resurfaced path mimics long-exposure photography, evoking the stilled motion of a passing train. This concept is expressed through the architecture and landscape elements.



At the **Entrance**, the long branches of an acacia tree and the paving patterns greet and direct you into the Station.



Learn about rail history while taking a break and waiting for your friends at **The Yard**, with green roof and solar panels.



Mature trees, which grew over old bricks at the **Community Lawn** have been kept to provide shade to users.



The **Kampung Garden** features ornamental shrubs and flowers iconic to Singapore's 1960s landscape.



The **Railway Staff Quarters** has been restored and adapted from a semi-detached house into a food and beverage establishment.



The **Herb & Spice Garden** showcases plants that were commonly used for homecooked dishes alongside a septic tank retained as a landscape feature.



The **Seating Terrace & Ramp** is a resting spot with a panoramic view of the restored Railway Station Building at different elevations.



The **Railway Station Building** has been restored together with original spaces i.e. an office, a waiting area and the Signal Room as well as some artefacts.



The **Heritage Rail Lawn** has the original three sets of rail tracks with 240 timber and 118 reinforced concrete sleepers. Two new wagons complete the nostalgic look.



The Station's **Platform** and artefacts like token pole and station name sign have been restored. Ramps have been added for easy access by users of all ages and abilities.



The 0.2 hectare **Event Lawn** is an expansive green lawn for recreation and public events.